

724091159

EL 400 \$988.61
30/05/2025 14:00:46

(Dealing No.)

WARNING : Folded or Mutilated Plans will not be accepted.
Plans may be rolled.
Information may not be placed in the outer margins.

4. Lodged by

(Include address, phone number, email, reference, and Lodger Code)

I. Existing		Created		
Title Reference	Description	New Lots	Road	Secondary Interests
51326607	Lot 154 on SP335062	1-3	-	Emts AA & BB

MORTGAGE ALLOCATIONS

Mortgage	Lots Fully Encumbered	Lots Partially Encumbered
721931891	1-3	-

6. Building Format Plans only.

I certify that :
* As far as it is practical to determine, no part of the building shown on this plan encroaches onto adjoining lots or road;
* Part of the building shown on this plan encroaches onto adjoining *lots and road

.....Cadastral Surveyor/Director* Date
*delete words not required

7. Lodgement Fees :

Survey Deposit	\$
Lodgement	\$
.....New Titles	\$
Photocopy	\$
Postage	\$
TOTAL	\$

8. Insert Plan Number
SP346181

2.Orig Grant Allocation :

3.References :

Dept File :
Local Govt :
Surveyor : BRSS7540.00A

5. Passed & Endorsed :

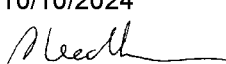
By : LandPartners Pty Ltd
Date : 10/10/2024
Signed : 
Designation : Plan Auditor

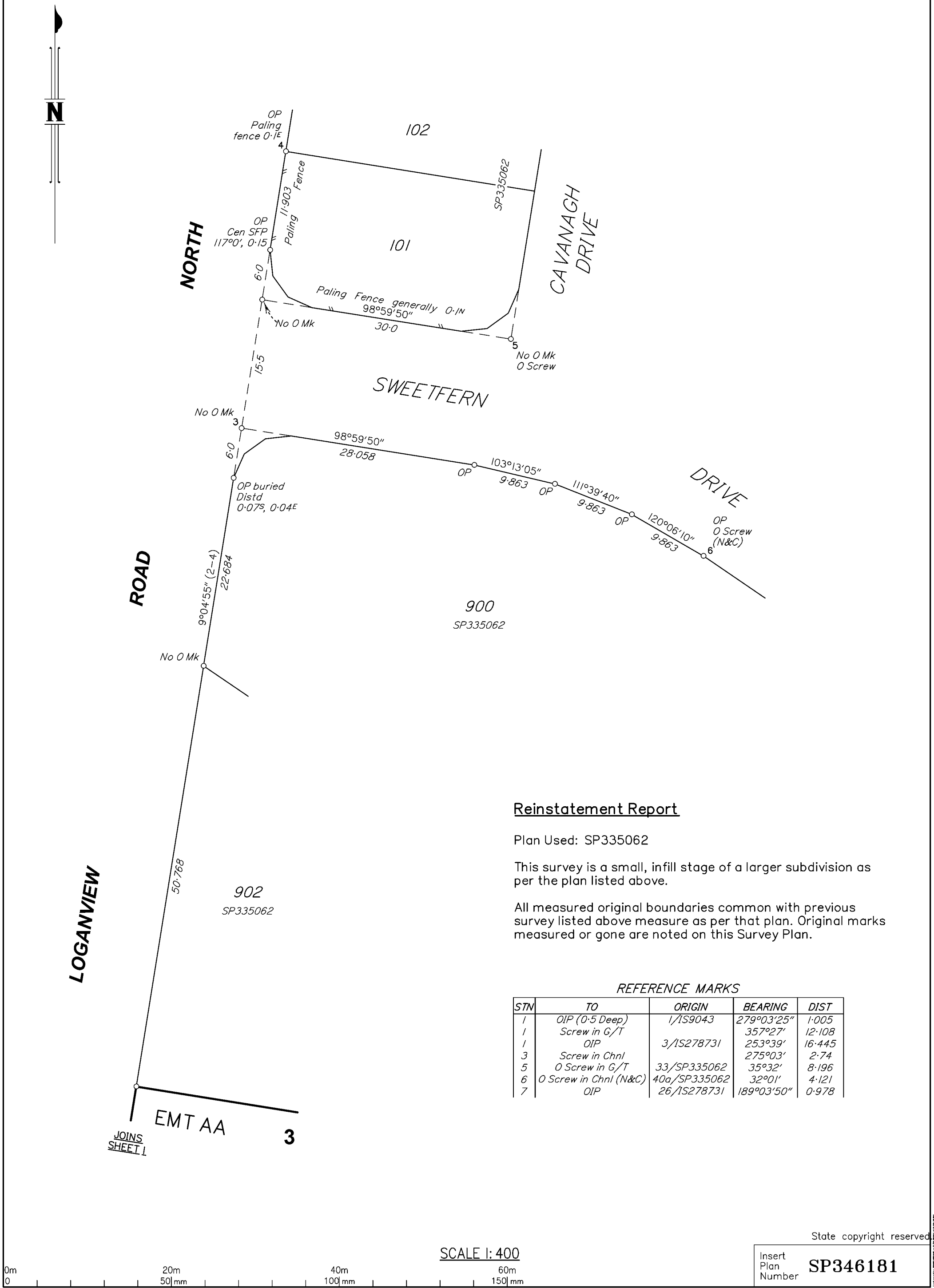

Reinstatement Report

Plan Used: SP335062

This survey is a small, infill stage of a larger subdivision as per the plan listed above.

All measured original boundaries common with previous survey listed above measure as per that plan. Original marks measured or gone are noted on this Survey Plan.

REFERENCE MARKS

STN	TO	ORIGIN	BEARING	DIST
1	OIP (0.5 Deep)	1/IS9043	279°03'25"	1.005
1	Screw in G/T		357°27'	12.108
1	OIP	3/IS278731	253°39'	16.445
3	Screw in Chnl		275°03'	2.74
5	O Screw in G/T	33/SP335062	35°32'	8.196
6	O Screw in Chnl (N&C)	40a/SP335062	32°01'	4.121
7	OIP	26/IS278731	189°03'50"	0.978